

Installation Instructions

安裝說明書

REAR ADD-ON SWAY BAR

後加裝型防傾桿, 17mm

#Q0499

Application 適用車型

TOYOTA PRUIS α / PRIUS V (ZVW40)

Components 內含配件

- ① Sway bar 防傾桿桿身1pcs
- ② Bracket-RH 支架-右1pcs
- ③ Bracket-LH 支架-左1pcs
- ④ Bolt 螺絲 (M10x1.5x25)8pcs
- ⑤ Nut 螺帽 (M10x1.5-17x10)8pcs
- ⑥ Washer 華司 (26x10.5x2)16pcs
- ⑦ Nut 螺帽 (M10x1.25-14x9)4pcs

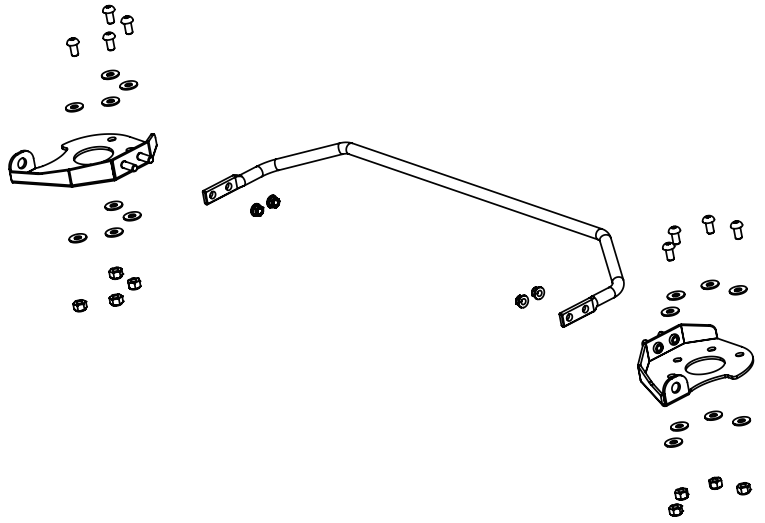

Caution 注意事項

- Installation is recommended to be performed by licensed mechanics with necessary tools to ensure safety. Incorrect installation may cause injury, damage to the product or vehicle.
安裝建議由合格的技師及工具執行以確保安全。安裝錯誤可能對人員、產品及車輛造成傷害。
- Note the routing of wires and cables before installation, or please refer to factory manual.
安裝前請事先記下線路的安裝路徑及位置以維持原廠配置。有疑問時請參考原廠手冊。
- Tighten bolts and nuts firmly by using handtools, and with specified torque if mentioned.
安裝過程請使用手動工具確實鎖緊螺帽及螺絲。如有特別註明請依照說明指示的扭力上鎖。

Instructions 安裝說明

1. Assemble the sway bar and the brackets using supplied M10x1.25 nuts.

使用附件M10x1.25螺帽。組裝防傾桿及兩側支架。

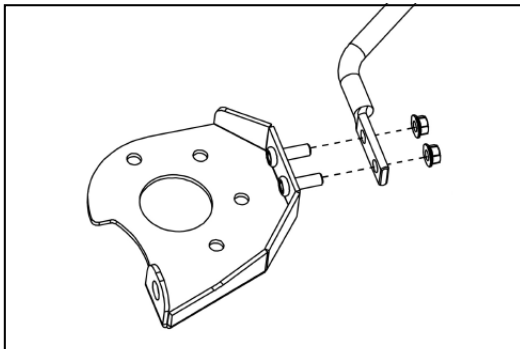

2. Remove rear shock absorber lower mounting nuts.

將後減震筒下端固定螺帽卸下。

3. Install the sway bar to the lower spring seat using supplied M10x1.5 bolts, nuts and washers.

使用附件M10x1.5螺絲、螺帽及華司。將防傾桿安裝至彈簧下座。

4. Reinstall the shock absorber mounting nuts.

將後減震筒固定螺帽重新鎖上。

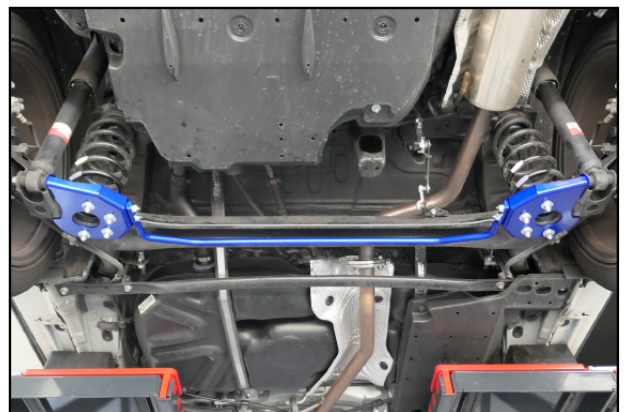
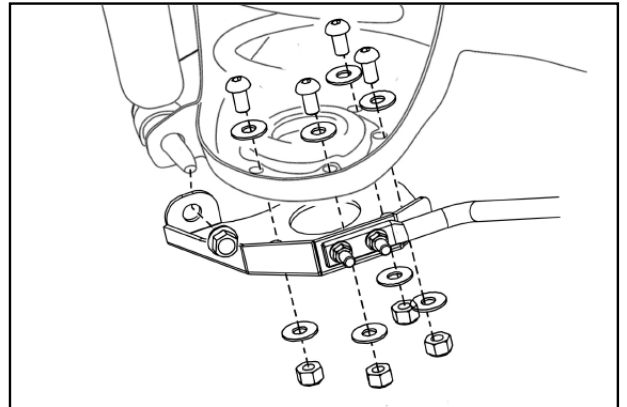

Illustration of installed state
安裝完成示意圖