

Installation Instructions

安裝說明書

BRAKE MASTER CYLINDER STOPPER

剎車總泵頂桿

#Q0398

Application 適用車型

Mazda CX-5 '12-
Mazda CX-9 '16-

For LHD models
左駕車型適用

Components 內含配件

- | | |
|---------------------------------|------|
| ① Bracket A 支架A..... | 1pcs |
| ② Bracket B 支架B..... | 1pcs |
| ③ Rubber 橡皮..... | 1pcs |
| ④ Nut 螺帽 (M10x1.25-14x9.5)..... | 2pcs |
| ⑤ Bolt 螺絲 (M6x1.0x20)..... | 3pcs |
| ⑥ Nut 螺帽 (M6x1.0-10x6)..... | 3pcs |
| ⑦ Washer 華司 (13x6.5x1.5)..... | 3pcs |

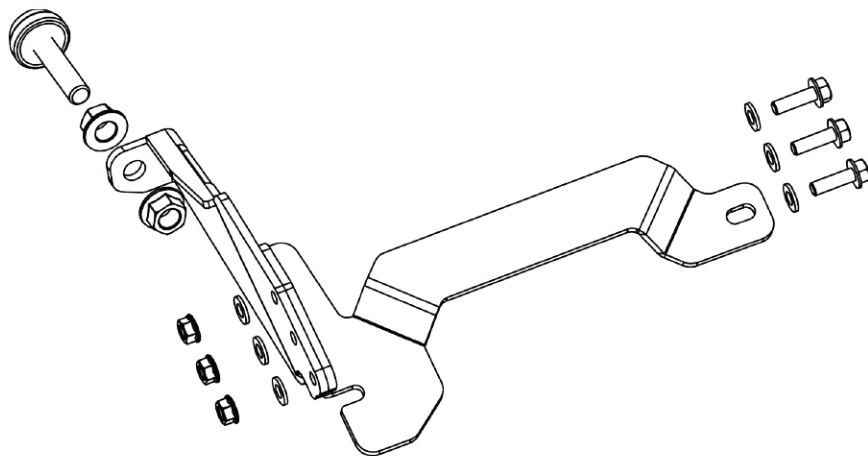

Caution 注意事項

- Installation is recommended to be performed by licensed mechanics with necessary tools to ensure safety. Incorrect installation may cause injury, damage to the product or vehicle. 安裝建議由合格的技師及工具執行以確保安全。安裝錯誤可能對人員、產品及車輛造成傷害。
- Note the routing of wires and cables before installation, or please refer to factory manual. 安裝前請事先記下線路的安裝路徑及位置以維持原廠配置。有疑問時請參考原廠手冊。
- Tighten bolts and nuts firmly by using handtools, and with specified torque if mentioned. 安裝過程請使用手動工具確實鎖緊螺帽及螺絲。如有特別註明請依照說明指示的扭力上鎖。

Instructions 安裝說明

1. Install supplied rubber to the bracket.
請參考配件圖，先將橡皮安裝於頂桿支架上。
2. Assemble the two brackets using supplied M6 bolts, nuts and washers. The two orientations are for different models. (See figure 1)
使用配件M6螺絲、螺帽及華司組裝支架。安裝方式依照車型分為兩種。(參考圖一)



3. Remove the factory battery bracket to replace them with the new brackets.
將原廠的電瓶固定架拆下並替換為新的支架。

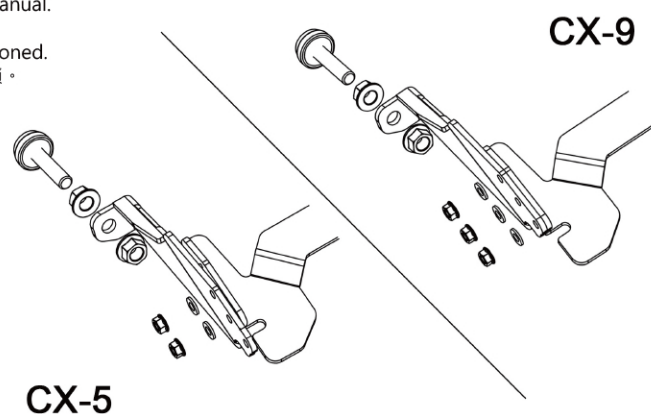

4. Adjust the nuts until the rubber contacts the brake master cylinder.
調整螺帽，使橡皮部分支撐於剎車總泵。



Illustration of installed state
安裝完成示意圖